

IRON \times WALLRAILS INSTALLATION

What you will need:

Tape Measure

Stud Finder

Drill / Screw Gun

Wall Anchors

PLANNING

1

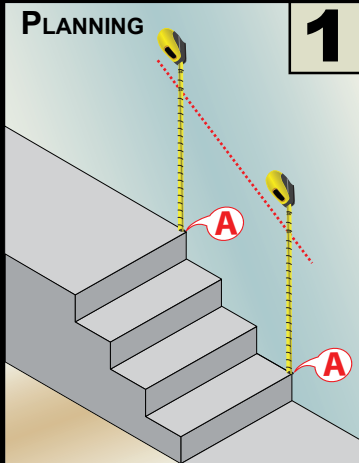

Determine your wall rail height. (typically 36") Place a mark on the wall 32½" (36"-3½") up from the nose (A) of the step. Be sure to measure vertically from the nose of the first and last step.

Draw a straight line connecting the two marks.

LAYOUT

2

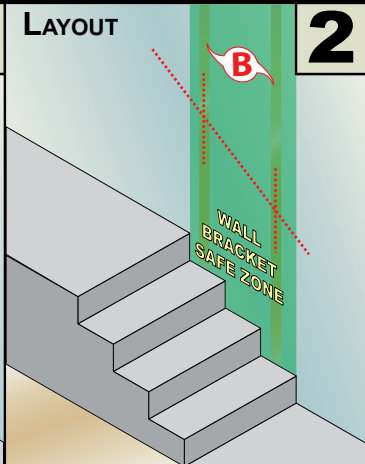

Locate the wall studs (B) and mark where they cross your line from step one. This is where your wall brackets will be mounted.

MOUNT THE BRACKETS

3

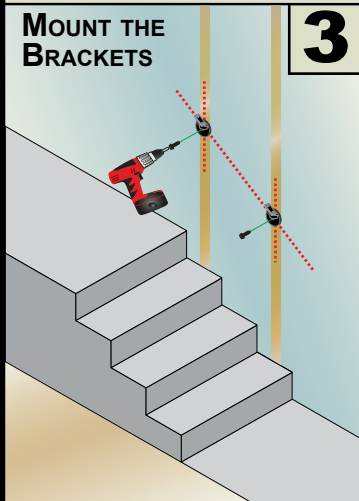

Install your brackets to the wall using an appropriate anchor. Tighten the wall anchors so the brackets are still able to rotate.

MOUNT THE HANDRAIL

4

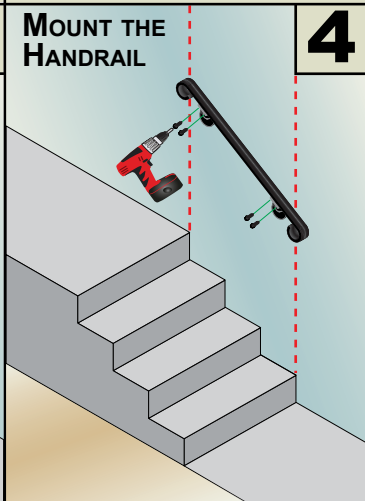

Place the handrail onto the wall brackets. Using a high speed screwgun, run the supplied self-drilling screws through the wall bracket into the bottom of the handrail.



PROUDLY MADE IN THE U.S.A.